

HCBWD Series 1/3" Wide Dynamic Camera

The new Honeywell 1/3" Sony Double Scan Wide Dynamic Camera provides excellent picture quality under all lighting conditions. The HCBWD Series is available either fully assembled with your choice of Semi-pinhole lens or as a camera housing only so that you can add the Honeywell Quick Change Fixed or Vari-focal Auto Iris Lens that best meets your unique surveillance requirements (see reverse for ordering information).

Fixed Lens shown

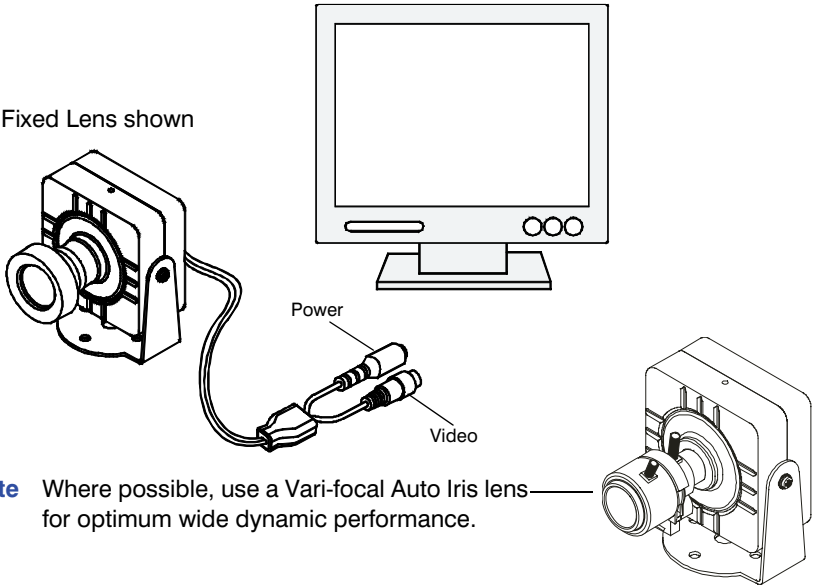

Note Where possible, use a Vari-focal Auto Iris lens for optimum wide dynamic performance.

To ease installation, the camera is factory assembled with the power/video cable plugged into the power/video connector on the camera board.

Caution When the camera is powered with 24 VAC, you **must** use the 24 VAC to 12 VDC converter (see figure below) to avoid permanent damage to the camera.

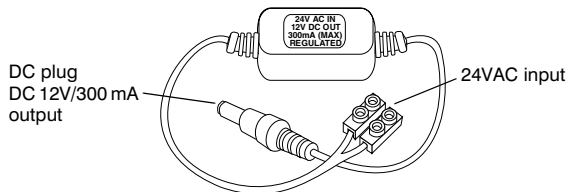

Ordering

Model No.	Description	Lens
HCBDWHR00*	1/3" CCD, Color, High Res, Wide Dynamic	2.9, 3.6, 6.0, 8.0 or 12 mm Fixed Lens*
HCBDWHR30	1/3" CCD, Color, High Res, Wide Dynamic	3.0 mm Semi-pinhole Lens
HCBDWHR37	1/3" CCD, Color, High Res, Wide Dynamic	3.7 mm Semi-pinhole Lens
HCBDWHR43	1/3" CCD, Color, High Res, Wide Dynamic	4.3 mm Semi-pinhole Lens
HCBDWHRVF**	1/3" CCD, Color, High Res, Wide Dynamic	2.6 - 6, 4.0 - 9.0, 9.0 - 22.0 mm VFAI Lens**

Note Use with any Honeywell Quick Change Lens below

* Fixed Lens Options

HLQ029 (2.9 mm) Fixed Lens
HLQ036 (3.6 mm) Fixed Lens
HLQ060 (6.0 mm) Fixed Lens
HLQ080 (8.0 mm) Fixed Lens
HLQ120 (12 mm) Fixed Lens

** Vari-focal Auto Iris Lens Options

HLQAV1 (4.0 - 9.0 mm) VFAI Lens
HLQAV2 (2.6 - 6.0 mm) VFAI Lens
HLQAV3 (9.0 - 22.0 mm) VFAI Lens
HLQVP4 (2.9, 3.6, 6.0, 8.0 mm) Variety Pack

Specifications

Video Signal	Power Requirements
Image Sensor: 1/3 in. Sony Interline Double Speed Color CCD	Input Voltage: 12 VDC or 24 VAC* (* with supplied 24 VAC to 12 VDC converter)
Automatic Electronic Shutter: 1/60 to 1/100,000 seconds	Input Voltage Range: 9 to 15 VDC, 20 to 28 VAC* (* with supplied 24 VAC to 12 VDC converter)
Video Standard: NTSC	Operating Temp: 14°F to 131°F (-10°C to 55°C)
Minimum Illumination: 1.0 lux @ F2.0	Storage Temp: -22°F to 158°F (-30°C to 70°C)
Dynamic Range: 64 dB (approx.)	Dimensions
Horizontal Resolution: 480 TV lines	Housing and Bracket (WxHxD): 0.5" x 2.13" x 1.93" (12.7 mm x 54 mm x 49 mm)
Auto Gain Control: Auto (4-26 dB max)	Weight: 2.82 oz (80 g) without lens
Sync System: Internal	
Gamma: 0.45	

Honeywell

Video Systems

www.honeywellvideo.com

+1.800.796.CCTV (North America only)

HVSsupport@honeywell.com

Document 900.0691 07/06 Rev 1.02

© 2006 Honeywell International Inc. All rights reserved. No part of this publication may be reproduced by any means without written permission from Honeywell Video Systems. The information in this publication is believed to be accurate in all respects. However, Honeywell Video Systems cannot assume responsibility for any consequences resulting from the use thereof. The information contained herein is subject to change without notice. Revisions or new editions to this publication may be issued to incorporate such changes.