

## HD5

### SUPER HIGH RESOLUTION, DAY/NIGHT OR ULTRA WIDE DYNAMIC COLOR INDOOR DOME CAMERAS

Honeywell's HD5 Series of indoor fixed dome cameras is ideal for discreet fixed camera surveillance where high-quality video is a necessity. Each unit packages a high-performance camera and a full-sized CS mount lens into a small, aesthetically pleasing 5-inch dome. In-ceiling and pendant dome options are available with black or white trim ring finishes, and smoke or clear lower domes.

The HD5 is highly customizable for your needs. There are two camera models to choose from: the super high-resolution 540 TVL camera or a Wide Dynamic Range camera that uses the Digital Pixel System® (DPS) sensor technology.

Easy accessible switches on the top of the camera make setup quick. The HD5U also comes with a one-button camera setup lever control to access the on-screen display menu. The compact flush one-piece mount design allows for fast, easy installation. A pendant mount and standard 4x4 electrical box kit is available for inconspicuous installation in virtually any application. A service/monitor cable is also included for easy on-site adjustments.

The HD5 is equipped, depending on your needs, with either a 2.7-13.5 mm or 5-50 mm varifocal auto iris or manual iris lens to cover a wide range of viewing angles. This is supplemented by easy picture adjustment via the 3D axis gimbal that is capable of 360° of pan, 180° of tilt and 360° of horizontal rotation.

The HD5 accepts either 12 V DC or 24 V AC (auto sensing) for proper operation and flexible installation. In addition, the HD5 Series is available in two transmission media (Coaxial or UTP) integrated inside the camera.

#### Market Opportunities

The HD5 is a general surveillance solution designed for object recognition required in locations where variable light and low light conditions exist. True color reproduction and excellent low light performance result in enhanced picture quality. Attractive cosmetic appearance makes HD5 Series dome cameras the ideal solution for a wide range of surveillance applications such as retail sites, casinos, banks, malls, residential applications or hotel lobbies – anywhere surveillance must be discreet.

#### Features

- 1/3" Sony HAD CCD™ or Ultra Wide Dynamic DPS imager
- Models available: 540 and 540 TVL Wide Dynamic
- Varifocal lenses available: 2.7-13.5 mm or 5-50 mm Auto Iris lenses, 2.7-13.5 mm or 5-50 mm Manual Iris lenses
- Pendant and back box mount kits available
- Black or white trim-ring finishes available
- Smoke or clear domes available
- Dual 12 V DC/24 V AC
- Local video output for setup
- Two transmission media (Coaxial, UTP) integrated inside the camera



HD5 Series  
(Black shown)

## SPECIFICATIONS

Operational	HD5CH, HD5CHTP/HD5CHX, HD5CHTPX	HD5U, HD5UTP/HD5UX, HD5UTPX
Video Standard	NTSC/PAL	NTSC/PAL
Scanning System	525 lines, 2:1; 625 lines, 2:1 Interlace	525 lines, 2:1; 625 lines, 2:1 Progressive
Image Sensor	1/3" Interline Transfer CCD	1/3" WDR digital image device
Number of Pixels (H x V)	768 x 494 (NTSC); 752 x 582 (PAL)	720 x 540
Minimum Illumination	0.6 lux @ F1.3	0.4 lux @ F1.3
Horizontal Resolution	540 TVL	
Video Output	1.0 Vp-p Coax @ 75 ohms 1.0 Vp-p UTP @ 100 ohms (All TP models)	
Sync System	12 V DC: Internal, 24 V AC: Line lock	
S/N Ratio	50 dB (AGC Off)	
Auto Gain Control	On/Off, switchable	Auto (0-36 dB maximum)
ALC	Direct Drive (DC) Auto Iris (only)	
Automatic Electronic Shutter	1/60 – 1/100,000 second; 1/50 – 1/100,000 second	
White Balance	Selectable ATW/AWC	ATW/AWB/ATW XtnD/ Manual
Line Lock Phase Adjust	Adjustable line lock vertical phase	
Lens Type	2.7-13.5 mm Auto or Manual 5-50 mm Auto or Manual	
AI/AES Selection	On/Off Switchable	
Gamma	0.45	
<b>Electrical</b>		
Input Voltage	12 V DC/24 V AC	
Input Range	11-16 V DC, 17-28 V AC	
Surge Suppression	1.5 kW Transient	
Power Consumption	3.5 W (max)	
<b>Mechanical</b>		
Dimensions (W x H)	6.4" x 5.1" (163.6 mm x 128.7 mm), camera only	
Weight	0.88 lb (0.4 kg) max (camera and lower bubble only)	
Housing Construction	PCABS (Polycarbonate/Acrylonitrile Butadiene Styrene blend)	
Video Output	BNC connector or UTP connector (twisted pair models)	
Power Input	12-inch tinned leads	

## SPECIFICATIONS

Environmental	
Temperature	Operating: 14°F to 122°F (-10°C to 50°C) Storage: -4°F to 140°F (-20°C to 60°C)
Relative Humidity	0% to 85% non-condensing
Mounts	
HD5-MK2	Flush Mounting Kit
HD5-PK	Pendant Mount Kit
Regulatory	
Emissions	FCC, CE (EN55022)
Immunity	CE (EN50130-4)
Safety	UL60065, EU LVD 2006/95/EC

HD5 with HD5-MK2 (optional)

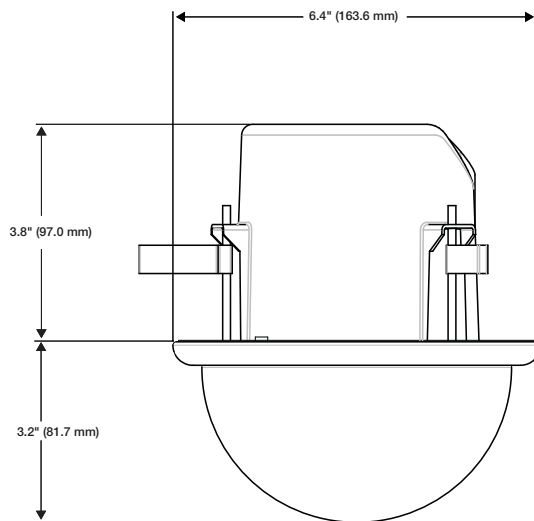

HD5 with HD5-PK (optional)

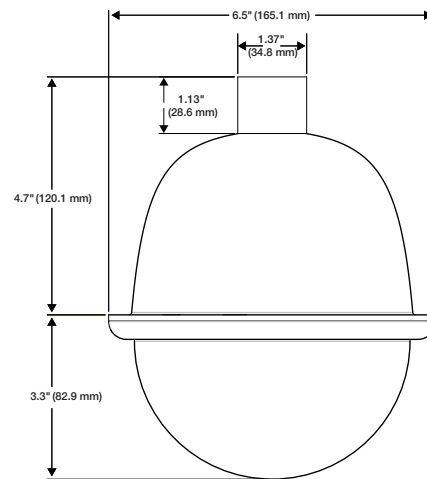

## Ordering

<b>Model</b> _____	<b>HD5</b>	<b>U</b>	<b>C</b>	<b>3</b>	<b>O</b>	<b>N</b>	<b>P</b>	
HD5								<b>Mounting Kit</b>
<b>Camera</b> _____								P Pendant Mount
C 540 TVL High Resolution								F Flush mount
U 540 TVL Wide Dynamic								O None
<b>CAT5 Option</b> _____								<b>Format</b>
C Coax								N NTSC
T UTP								P PAL
<b>Lens</b> _____								<b>Bubble / Trim Ring *</b>
2 2.7-13.5 mm AI Varifocal								A Clear Bubble/Black Trim
3 2.7-13.5 mm MI Varifocal								B Clear Bubble/White Trim
5 5-50 mm AI Varifocal								C Smoke Bubble/Black Trim
6 5-50 mm MI Varifocal								D Smoke Bubble/White Trim
								O No Bubble

\* Gold or Chrome bubble options also available. Contact Inside Sales at 1.800.323.4576 for ordering information.

**For more information:**

[www.honeywell.com/security](http://www.honeywell.com/security)

**Automation and Control Solutions**

Honeywell Security Products Americas  
2700 Blankenbaker Pkwy, Suite 150  
Louisville, KY 40299  
1.800.323.4576  
[www.honeywell.com](http://www.honeywell.com)

L/HD5D/D  
May 2013  
© 2013 Honeywell International Inc.

**Honeywell**